

INTERNATIONAL MULTISENSORY RESEARCH FORUM

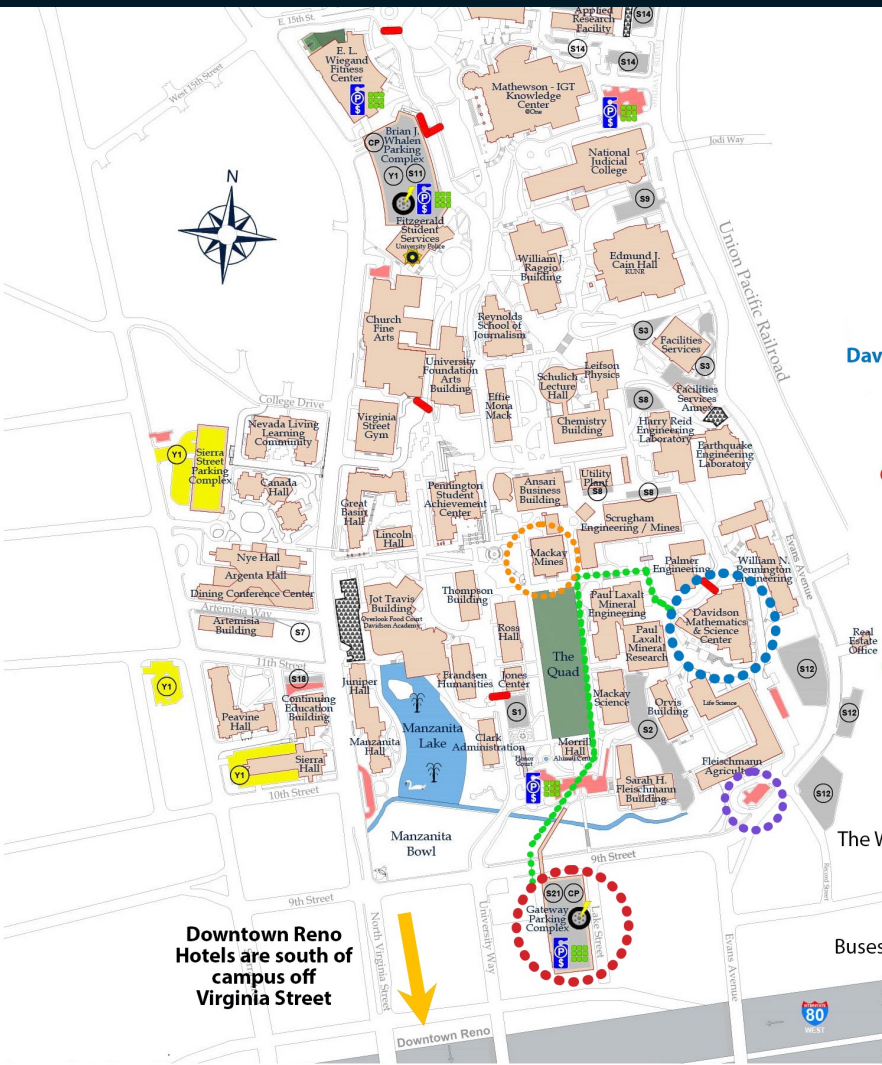

RENO, NV | 2024

	Monday, June 17th	Tuesday, June 18th	Wednesday, June 19th	Thursday, June 20th
8:00 AM		Continental Breakfast	Travel to Tahoe	Continental Breakfast
9:00 AM		Talk Session 3: Audio-visual		Continental Breakfast
10:00 AM		Coffee	Talk Session 4: Learning	Coffee
11:00 AM	Registration	Symposium 2: From Lipreading to Listening: How Visual Cues Shape Auditory Speech Processing	Break	Symposium 8: Shifting Sensory Reliance: Adaptive Strategies in Vision Impairment and Blindness
12:00 PM	Opening Remarks	Posters	Symposium 5 (invited): Processes of Multisensory Learning	Break
1:00 PM	Talk Session 1: Haptic/ Tactile/ Somatosensory	Lunch and Posters	Lunch	Talk Session 6: Visual-vestibular Interactions and Self-motion
2:00 PM	Posters	Symposium 3: From Passive to Active: the Influence of Active Perception on Multisensory Processing	Symposium 6: Multisensory Development in Humans from Birth through Young Adulthood	Grab and Go Lunch
3:00 PM	Symposium 1: Contributions of Innate Constraints and Experience to the Development of Visual Cortex: Evidence from Infants and Blind Adults			Coffee
4:00 PM	Coffee	Symposium 4: Unravelling the Neural Mechanisms of Multisensory Self-Motion Processing: From Primate Models to Clinical Applications	Symposium 7 (invited): Multisensory Processing in Mouse and Insect Models	
5:00 PM	Talk Session 2: Modeling	Break	Break	
6:00 PM	Break	Keynote 2: Dr. Jennifer Groh	Keynote 3: Dr. Marc Ernst	
7:00 PM	Keynote 1: Dr. Uta Noppeney		Break	
8:00 PM	Reception and Posters		Banquet	
9:00 PM			Travel from Tahoe	



IMRF Sessions will be held in the **Davidson Math and Science Center (in the blue circle)**.

Parking for IMRF available on the 2nd and 3rd floors of the **Gateway Parking Complex (in the red circle)**. Purchase a parking permit on the website or at registration.

Pedestrian bridge to campus is on the 4th Floor. **Follow the walking path (shown by the green dots)** to Davidson Math and Science Center.

ADA access through **Paul Laxalt Mineral Engineering**

The Welcome Social on Monday night will include a tour of the **Keck Mineral Museum (in the orange circle)**

Buses for A Day at the Lake will pick up in front of **Fleischmann Agriculture (in the purple circle)**

Downtown Reno Hotels are south of campus off Virginia Street

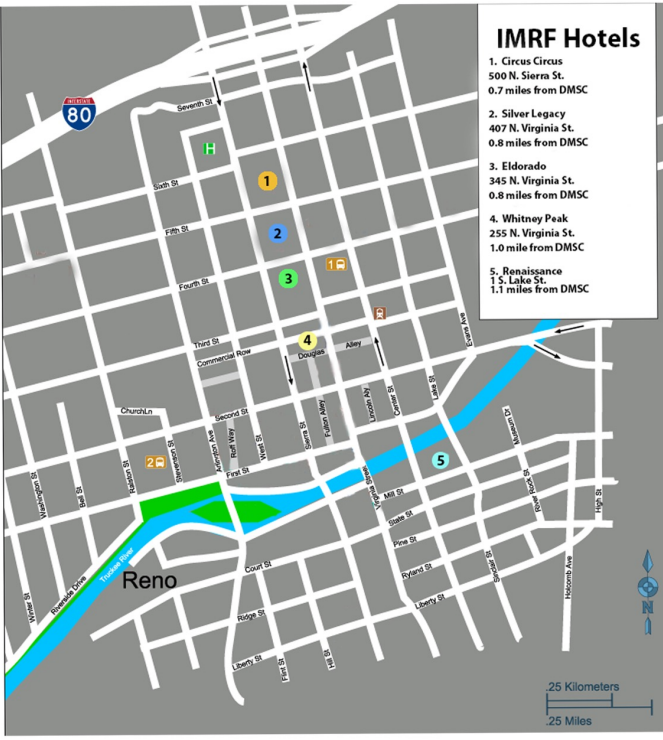

- IMRF Hotels**
1. Circus Circus
500 N. Sierra St.
0.7 miles from DMSC
 2. Silver Legacy
407 N. Virginia St.
0.8 miles from DMSC
 3. Eldorado
345 N. Virginia St.
0.8 miles from DMSC
 4. Whitney Peak
255 N. Virginia St.
1.0 mile from DMSC
 5. Renaissance
1.5 Lake St.
1.1 miles from DMSC



**University of Nevada, Reno
Campus Map (top)**

Downtown Reno Map (left)



University of Nevada, Reno

Office of the Provost
College of Science
Psychology Department
Research & Innovation

Institute for Neuroscience
Integrative Neuroscience:
Center of biomedical
Research Excellence

